



Wrist bands Active



LUX-IDent s.r.o. – headquarters [production, sales, R & D]
Tovární 368, 563 01 Lanškroun, Czech Republic
Tel.: +420 465 352 500
e-mail: info@lux-ident.com
www.lux-ident.com

LUX-IDent Germany GmbH – branch office [sales, R & D]
Rudolf-Diesel-Ring 21, 82054 Sauerlach, Germany
Tel.: +49 8104 805 502
e-mail: smart-inlays@lux-ident.com
www.lux-ident.com



A range of applications.

Wrist band Active is a perfected line of our previous wrist band type Ultrasonic.

Wrist band is a portable transponder used widely for access control in swimming pools, aqua parks, health and fitness centres or amusement parks. It provides outstanding performance and durability in harsh environmental conditions.

Our wrist bands are completely waterproof as they have gone through highly sophisticated processes, such as ultrasonic welding, to seal the housing.

All our wrist bands undergo various stringent quality tests throughout the production process.

FEATURES

- Non-allergenic materials: housing (ABS), strap (nylon), buckle (stainless steel)
- Housing colours: black, red, blue, green, yellow, orange, purple, white and grey
- Operating temperature: from $-20\text{ }^{\circ}\text{C}$ to $+60\text{ }^{\circ}\text{C}$ [suitable for sauna]
- Humidity resistance: suitable for indoor and outdoor use
- Waterproof
- Optimized reading distance
- Attractive design
- Possibility of combining two technologies in one wrist band
- The product can be personalized by full colour printing or long-lasting laser engraving, using your logo, a number or any graphic motive

DIMENSIONS

[mm]

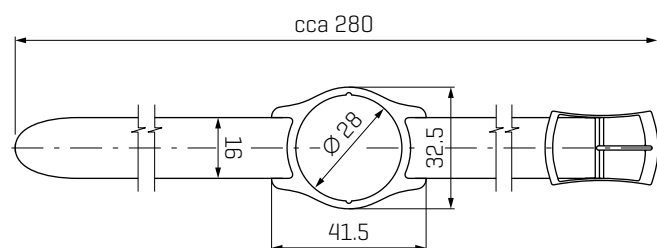

AVAILABLE CHIP TECHNOLOGIES

Manufacturer frequency	Chip type
EM Microelectronic	
LF 125 /134.2 kHz	EM4102, EM4200, EM4305, EM4450
NXP	
LF 125 /134.2 kHz	Hitag® 1, Hitag® 2, Hitag® S 256bit, Hitag® S 2048bit
HF 13.56 MHz	MIFARE Ultralight® C, MIFARE Ultralight® EV1, MIFARE Classic® 1K EV1, MIFARE Classic® 4K EV1, MIFARE® DESFire® 256B EV1, MIFARE® DESFire® 2K EV1/EV2, MIFARE® DESFire® 4K EV1/EV2, MIFARE® DESFire® 8K EV1/EV2, MIFARE Plus® SE, MIFARE Plus® S 2K, MIFARE Plus® S 4K, MIFARE Plus® X 2K, MIFARE Plus® X 4K, MIFARE Plus® EV1 2K, MIFARE Plus® EV1 4K I-Code® SLIX NTAG213, NTAG215, NTAG216 SmartMX (JCOP)
Infineon	
HF 13.56 MHz	NRG SLE66R35 1K
Microchip – Atmel	
LF 125 /134.2 kHz	ATA5575M1, ATA5575M2, ATA5577, Q5
LEGIC®	
HF 13.56 MHz	Prime: MIM256, MIM1024 Advant: ATC256-MV410, ATC1024-MV110, ATC1024-MV010, ATC4096-MP311 CTC 4096-MP410, CTC 4096-MM410
Silicon Craft	
LF 125 /134.2 kHz	SIC7999 (HDX)

Other ICs are available upon request.